



Office of General Services

DESIGN & CONSTRUCTION GROUP
THE GOVERNOR NELSON A. ROCKEFELLER
EMPIRE STATE PLAZA
ALBANY, NY 12242

ADDENDUM NO. 3 TO PROJECT NO. 47407

CONSTRUCTION WORK REPAIR BASEMENT CONCRETE & SIDEWALKS SHIRLEY CHISHOLM STATE OFFICE BUILDING 55 HANSON PLACE BROOKLYN, NY

May 14, 2025

NOTE: This Addendum forms a part of the Contract Documents. Insert it in the Project Manual. Acknowledge receipt of this Addendum in the space provided on the Bid Form.

SPECIFICATIONS

1. SECTION 015000 CONSTRUCTION FACILITIES & TEMPORARY CONTROLS: Discard the Section bound in the Project Manual and substitute with the accompanying Section (pages 015000 – 1 thru 015000 – 6) noted “Addendum #3; Revised 05/13/2025”.

DRAWINGS

2. Drawing No. S-102:
 - a. NOTES, Add the following Note:

“FOR BID PURPOSES ONLY, ASSUME THICKNESS OF FULL DEPTH CONCRETE REPAIR INDICATED ON SHEET S-102, REFERENCING DETAIL 5/S-301, IS 12 INCHES. VERIFY THICKNESS IN FIELD.”
3. Drawing No. E-001:
 - a. DISPOSAL OF MERCURY CONTAINING LAMPS: Delete Block in its entirety.
 - b. DISPOSAL OF PCB CONTAINING BALLASTS: Delete Block in its entirety.
4. Revised Drawings:
 - a. Drawing Nos. G-003, C-200 and C-301, noted “REVISED DRAWING 05/13/2025” accompany this Addendum and supersede the same numbered originally issued drawings.
 - b. Drawing No. C-101, noted “REVISED DRAWING 05/13/2025” accompanies this Addendum and supersedes the same numbered previously issued drawing.

END OF ADDENDUM

Brady Sherlock, P.E.
Director, Division of Design
Design & Construction

SECTION 015000

CONSTRUCTION FACILITIES & TEMPORARY CONTROLS

PART 1 GENERAL

1.01 PROJECT CONDITIONS

- A. Provide construction facilities and temporary controls necessary for the Work.

1.02 TEMPORARY LIGHT AND POWER

- A. Electric energy will be made available without charge, at source or sources directed, for lighting and for power tools. Power supply for motors rated in excess of 1/2 hp will be made available within the limits of the existing circuitry and usage.
- B. Provide temporary lighting as required to maintain a minimum of 10 foot candles in the work areas.
- C. Provide ground-fault protection for personnel (such as portable plug-in type ground-fault circuit-interrupters) on single phase 15 and 20 ampere receptacle outlets which are in use.
- D. Receptacle outlets and portable cord connectors shall have standard NEMA configuration.
- E. Provide temporary wiring and equipment in conformance with the National Electrical Code.

1.03 TEMPORARY WATER

- A. Water will be made available for the Work without charge at source or sources directed within the limits of the existing supply and usage.
- B. Prevent waste of water.

1.04 TEMPORARY TOILETS

- A. Construction Work Contract: Provide toilet facilities for Contractor's and subcontractors employees engaged on the Project, including employees of other contractors. Locate toilets where directed and maintain them in a sanitary condition.

NUMBER OF EMPLOYEES	MINIMUM NUMBER OF FACILITIES
20 or less	1 toilet
20 or more	1 toilet and 1 urinal per 40 employees

*Toilet/Urinal Combinations shall count as only one facility.

1. Where water and sewer connections are available, provide water closets, otherwise provide approved chemical or electric toilets.
2. Inside buildings, locate toilet facilities no more than 4 stories or 60 feet above or below, nor more than 500 feet travel on the same level from the work location of any person.
3. Locate toilet facilities no more than 1000 feet from any work location.

1.05 BARRIERS AND ENCLOSURES

- A. Provide barriers during performance of the Work to:
 1. Prevent unauthorized entry to work areas.
 2. Allow for State's occupancy of Site.
 3. Protect existing facilities and adjacent properties from damage.
 4. Protect vehicular and pedestrian traffic.
- B. Temporary Dust Barriers: Provide temporary dust barriers to prevent the spread of dust from the work areas. Construct the dust barriers of wood framing sheathed with 6 mil polyethylene film. Secure the dust barriers in place without damaging existing construction.

1.06 TEMPORARY FENCE ENCLOSURE

- A. Construction Work Contract – Contractor Staging Areas:
 1. Provide temporary fence not less than 8 feet in height above grade.
 2. Fabric: #9 gage galvanized steel, or equal gage aluminum, woven together into 2-inch diamond mesh, with both top and bottom edges having a twisted and barbed finish.
 3. Posts, Rails, and Connections: Standard galvanized steel products of an approved manufacturer, of the size and types as required and approved. Provide top and bottom rails between all posts, secured with bolted connections.
 4. Gates: Provide access gates for passage of employees and materials, complete with padlock. Fabricate gates with galvanized steel pipe perimeter covered with same fabric specified for fence. Furnish the Director's Representative with 2 keys per gate.
 5. Provide each post and gate with "V" shaped extension arms and with 3 strands per side of 4 point heavy galvanized steel barbed wire.
 6. Erection: Set posts 4 feet into the ground and not more than 10 feet apart. Install bottom rail not more than 2 inches above existing grade. Pull fabric taut and wire tightly to posts and rails at not more than 2 feet on center.
 7. Provide concrete Jersey Barriers in front of the fencing on the roadway side where traffic will be active.
 8. Maintain the temporary fence enclosure throughout the life of the Contract, or until directed to be removed. Replace all items or portions of fence enclosure damaged or destroyed.
- B. Construction Work Contract – Pedestrian Walkway Fence:
 1. Provide temporary fence not less than 8 feet in height above grade.

2. Fabric: #9 gage galvanized steel, or equal gage aluminum, woven together into 2 inch diamond mesh, with both top and bottom edges having a twisted and barbed finish.
3. Posts, Rails, and Connections: Standard galvanized steel products of an approved manufacturer, of the size and types as required and approved. Provide top and bottom rails between all posts, secured with bolted connections.
4. Erection: Bases shall be weighted down with sand bags. Set posts not more than 10 feet apart. Pull fabric taut and wire tightly to posts and rails at not more than 2 feet on center.
5. Provide fabric behind the woven mesh to provide a security screen so people traveling through the north tube cannot visually see the items in the south tube.
7. Maintain the temporary fence enclosure throughout the life of the Contract, or until directed to be removed.

1.07 PROTECTION OF WORK AND EXISTING PROPERTY

- A. Protect installed Work and existing construction and finishes during performance of the Work.
- B. Maintain the building in a watertight condition during performance of the Work.
- C. Provide temporary and removable protection for installed products. Control activity in immediate work area to prevent damage.
- D. Provide protective coverings at wall projections, jambs, sills, and soffits of openings.
- E. Protect finished floors, stairs, and other surfaces from traffic, dirt, wear, damage, and movement of heavy objects by covering them with durable sheet materials.
- F. Protect smoke detectors from airborne dust and debris.
 1. At the beginning of each work day, provide protective coverings over smoke detectors in areas where airborne dust and debris will be generated by the Work.
 2. At the end of the work day, clean the areas in which the smoke detectors are located by whatever means necessary to assure that airborne dust and debris will not contaminate the smoke detectors, then remove protective coverings.
 3. Provide signs, instructions and alternate methods for reporting a fire during the periods that the smoke detectors are covered.
 4. Notify the Director's Representative and have procedures approved.
- G. Prohibit traffic or storage upon waterproofed and roofed surfaces. If traffic or activity is necessary, obtain recommendations for protection from waterproofing or roofing material manufacturer.
- H. Protect existing trees and plants during performance of the Work unless otherwise indicated. Box trees and plants within the grading limit lines. Do not

deposit excavated materials or store building materials around trees or plants. Do not attach guy wires to trees.

- I. Prohibit traffic from landscaped areas.
- J. Cleaning tools of cementitious and other insoluble materials:
 - 1. Do not wash tools in sinks or other sanitary drainage systems. Protect all drainage systems from debris that can clog or damage piping and fixtures.
 - 2. Take all precautions necessary to prevent cementitious and other insoluble materials from flowing into floor drains.
 - 3. Dispose of excess cementitious and other insoluble debris with the other rubbish.

1.08 SECURITY

- A. Key Deposits: A \$25 deposit will be required for each key issued by the Facility. Deposits will be refunded upon return of the keys.
- B. Facility Key Regulations:
 - 1. Sign Facility keys out and in on a daily basis unless otherwise directed.
 - 2. Keep keys on person at all times while on the premises. Do not loan or give keys to other persons.
 - 3. Do not remove keys from the premises without written permission from the Director's Representative.
 - 4. Report lost, missing, or stolen keys immediately to the Facility Safety/Security Department. Assume responsibility for cost of necessary key and lock replacement as a result of lost, missing, or stolen keys.
- C. Identification Cards: Provide employee name and company name.
- D. Promptly relock doors and security screens located in access routes, storage areas, and work areas after use.
- E. Restore, by the end of each work day, existing in place safety/security items such as doors, screens, alarm systems components, that required removal, replacement, or adjustment to perform the Work, unless otherwise authorized in writing by the Director's Representative.
- F. Remove all tools and materials from patient occupied work areas when the work areas are not attended by employees and at the end of each work day. Store tools in a locked tool box, cabinet, or shed. Store materials where directed in a location secure from access by patients and clients.

1.09 WATER CONTROLS

- A. Provide and maintain pumping equipment necessary to keep the work areas free from water. Discharge water into existing storm drainage systems or otherwise disperse as directed.

1.10 FIRE PREVENTION

- A. Take precautions necessary to prevent fires.
- B. Fuel for cutting and heating torches shall be gas only, and shall be contained in Underwriters Laboratory approved containers.
- C. Furnish and maintain a currently inspected 20 pound capacity multi-class A B C fire extinguisher in the immediate vicinity where welding tools or torches are in use.
- D. Furnish and maintain a currently inspected fire extinguisher of the appropriate class and size whenever the temporary storage of materials changes that areas classification of fire load or life safety.
- E. Do not use flammable liquids, other than those specified, within a building without written approval from the Director's Representative.
- F. Tarpaulins shall be flameproof and shall be securely anchored when attached to scaffolding or when used to enclose any portion of a building.
- G. If required by the nature of the work and facility regulations, the Contractor shall obtain from the facility and pay all costs associated with "Hot Work Permits" including fire watches to execute the work of its contract. Perform hot work in accordance with the Fire Code of New York State and the Hot Work Program approved for the work. Prior to, during and after performing hot work, inspect the hot work area for compliance with the requirements of the permitted Hot Work Program.
 - 1. Post signage "Caution: Hot Work In Progress - Stay Clear" in conspicuous locations warning others before they enter a hot work area where the area is accessible to persons other than the operator of the hot work equipment.
 - 2. See applicable facility permits and conditions bound in the Appendix.

1.11 TEMPORARY FIRE PROTECTION

- A. If the existing building is to be partially occupied during the course of the project, all existing exits, fire walls, fire barriers and fire protection systems shall be continuously maintained in the occupied phases in compliance with the Fire Code of New York State. Comply with NFPA 241 for items not specifically addressed in the Fire Code of New York State.
- B. Those portions occupied by the facility must be available for their use 24 hours a day, seven days a week during the contract period unless otherwise scheduled in these documents.
- C. Prior to removal of existing fire protection systems, if such removal is part of the work, install equivalent temporary fire protection systems as defined in these documents and as approved by the Director's Representative and/or the facilities representative.

- D. The cost of all labor, fire watches, variances, materials, installations, maintenance and removal of such temporary fire protection systems or modifications to the existing systems are the responsibility of the Contractor. Install permanent fire walls, fire barriers and fire protection systems, if provided as part of the work, as soon as practical.

1.12 ACCESS ROADS

- A. Routes of ingress and egress on the premises to the location of the Work shall be as directed.

1.13 PARKING

- A. No parking will be allowed at the site, except for vehicles delivering material and equipment while they are being unloaded.

1.14 RUBBISH REMOVAL

- A. Clean up and containerize the rubbish (refuse, debris, waste materials, and removed materials and equipment) resulting from the Work at the end of each work day and leave work areas broom clean, except where more stringent cleaning is specified. Locate containerized rubbish where directed.
- B. Remove rubbish from State property at least once a week and more often if the rubbish presents a hazard. Properly dispose of rubbish.
- C. Burning of rubbish will not be permitted.

1.15 RELOCATION AND REMOVALS

- A. Should a change in location of any construction facilities and temporary controls be necessary in order to progress the Work properly, remove and relocate such items as directed.
- B. Remove the construction facilities and temporary controls when they are no longer required. Restore permanent facilities used for or connected to temporary facilities to their original condition or better.

PART 2 PRODUCTS (Not Used)

PART 3 EXECUTION (Not Used)

END OF SECTION



WARNING:
THE ALTERATION OF THIS MATERIAL IN ANY WAY, UNLESS DONE UNDER THE DIRECTION OF A COMPARABLE PROFESSIONAL, I.E. ARCHITECT FOR AN ARCHITECT, ENGINEER FOR AN ENGINEER OR LANDSCAPE ARCHITECT FOR A LANDSCAPE ARCHITECT, IS A VIOLATION OF THE NEW YORK STATE EDUCATION LAW AND/OR REGULATIONS AND IS A CLASS 'A' MISDEMEANOR.

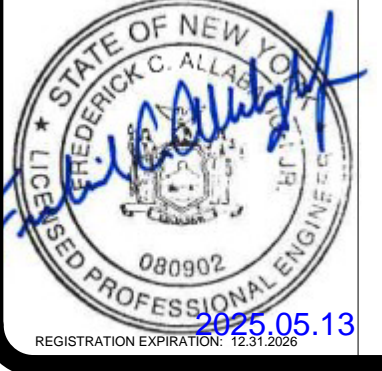

CONTRACT: **CONSTRUCTION**
TITLE: **REPAIR BASEMENT CONCRETE & SIDEWALKS**
LOCATION: **SHIRLEY A CHISHOLM SOB
55 HANSON PLACE
BROOKLYN, NY 11217**
CLIENT: **NEW YORK STATE OFFICE OF
GENERAL SERVICES**

2	2025.05.13	ADDENDUM #3
1	2024.11.13	100% BACKCHECK
MARK	DATE	DESCRIPTION
PROJECT NUMBER:	47407-C	
DESIGNED BY:	JMK	
DRAWN BY:	JMK	
CHECKED:	-	
APPROVED:	-	

SITE STAGING PLAN

DRAWING NUMBER: **G-003**

CONSTRUCTION SEQUENCE AND STAGING:

GENERAL

- THE FOLLOWING IS A SUGGESTED CONSTRUCTION SEQUENCE. CONTRACTOR TO DEVELOP THEIR OWN PLAN AND SUBMIT FOR APPROVAL PRIOR TO COMMENCING WORK.
- ALL STAGING AREAS SHOWN ON G-003 ARE TO BE PROTECTED WITH TEMPORARY METAL FENCING AND JERSEY BARRIERS AS NOTED IN SPECIFICATION SECTION 015000, PARAGRAPH 1.06-A.
- THE INTENT OF THE CONSTRUCTION SEQUENCE IS TO COMPLETE THE CURB WORK FIRST ON SOUTH ELLIOT PLACE, THEN HANSON PLACE, AND FINALLY FORT GREENE PLACE SO THE EXISTING CONCRETE SIDEWALK CAN REMAIN PARTIALLY OPEN FOR PEDESTRIAN TRAFFIC. TEMPORARY FENCING TO BE PROVIDED AS NOTED IN SPECIFICATION SECTION 015000, PARAGRAPH 1.06-B.
 - CONTRACTOR SHALL COORDINATE WITH THE DIRECTOR'S REPRESENTATIVE WHEN THE WORK IS OCCURRING ON SOUTH ELLIOT PLACE. PART OF THE SCOPE OF WORK IS TO REPLACE STRUCTURAL PLANKS OVER THE TOP OF VAULTS LOCATED UNDER THE SIDEWALK. WHEN THIS WORK OCCURS, THE ENTIRE SIDEWALK WILL NEED TO BE SHUT DOWN TO PEDESTRIAN ACCESS.
 - WHEN THE STRUCTURAL PLANKS ARE BEING REPLACED ON SOUTH ELLIOT STREET, THE CONTRACTOR SHALL SCHEDULE TO HAVE THE 4' TOPPING 'PUMPED' FROM THE STREET LEVEL TO THE BASEMENT GENERATOR ROOM.
- THE BUILDING'S MAIN ENTRANCES FOR PEDESTRIANS MUST BE LEFT ACCESSIBLE 24 HOURS A DAY, 7 DAYS A WEEK. WHEN WORK IS TO BE COMPLETED IN FRONT OF THESE AREAS, THE CONTRACTOR MUST SCHEDULE THIS WORK IN ADVANCE WITH THE FACILITY AND THE DIRECTOR'S REPRESENTATIVE.
- THE LOCATION NOTED AS 'LOADING DOCK' ON G-003 IS WHERE THE MAIN LOADING DOCK TO THE FACILITY IS LOCATED. THIS AREA IS NOT TO BE FENCED OFF AS ACCESS FOR DELIVERIES WILL BE REQUIRED THROUGHOUT CONSTRUCTION. WHEN WORK IS TO BE COMPLETED IN FRONT OF THIS AREA, THE CONTRACTOR MUST SCHEDULE THIS WORK IN ADVANCE WITH THE FACILITY AND THE DIRECTOR'S REPRESENTATIVE.
- PRIOR TO REPLACEMENT OF THE CONCRETE CURBS ON HANSON PLACE, CONTRACTOR SHALL REVIEW WITH THE FACILITY AND THE DIRECTOR'S REPRESENTATIVE THE EXACT LOCATIONS OF THE CON-EDISON VAULTS ON THIS STREET.

CONSTRUCTION SEQUENCE - SOUTH ELLIOT PLACE

- CONTRACTOR SHALL START WITH ESTABLISHING STAGING AREA #1 AND STAGING AREA #2 WITH TEMPORARY FENCING AND JERSEY BARRIERS.
- STAGING AREA #1 WILL BE USED FOR CONTRACTOR PROTECTION WHILE REMOVING AND INSTALLING THE CONCRETE CURB AND HALF OF THE SIDEWALK ALONG SOUTH ELLIOT PLACE. STAGING AREA #2 SHALL BE USED FOR STORAGE OF CONTRACTOR MATERIALS.
- CONTRACTOR SHALL PLACE TEMPORARY PEDESTRIAN FENCING ON THE CONCRETE WALKWAY CLOSEST TO THE BUILDING TO ESTABLISH TEMPORARY PEDESTRIAN WALKWAY #1.
- ONCE THE CONCRETE CURB AND CONCRETE WALKWAY WORK IS COMPLETED CLOSEST TO SOUTH ELLIOT PLACE, THE CONTRACTOR CAN USE STAGING AREA #1 AS A PEDESTRIAN WALKWAY AND COMPLETE THE CONCRETE WORK CLOSEST TO THE BUILDING.

CONSTRUCTION SEQUENCE - HANSON PLACE (EAST END)

- CONTRACTOR SHALL START WITH ESTABLISHING STAGING AREA #3.
- STAGING AREA #1 IS TO BE REMOVED IN ITS ENTIRETY AND THE STREET RETURNED TO NORMAL USE. REPAIR DAMAGE CAUSED BY THE POSTS BEING SET IN THE ASPHALT (STREET).
- CONTRACTOR SHALL MOVE STORAGE MATERIALS FROM STAGING AREA #2 TO STAGING AREA #3.
- STAGING AREA #2 WILL BE USED FOR CONTRACTOR PROTECTION WHILE REMOVING AND INSTALLING THE CONCRETE CURB AND HALF OF THE SIDEWALK ALONG THE EAST END OF HANSON PLACE. STAGING AREA #3 SHALL BE USED FOR STORAGE OF CONTRACTOR MATERIALS.
- CONTRACTOR SHALL PLACE TEMPORARY PEDESTRIAN FENCING ON THE CONCRETE WALKWAY CLOSEST TO THE BUILDING TO ESTABLISH TEMPORARY PEDESTRIAN WALKWAY #2.
- ONCE THE CONCRETE CURB AND CONCRETE WALKWAY WORK IS COMPLETED CLOSEST TO THE EAST END OF HANSON PLACE, THE CONTRACTOR CAN USE STAGING AREA #2 AS A PEDESTRIAN WALKWAY AND COMPLETE THE CONCRETE WORK CLOSEST TO THE BUILDING.

CONSTRUCTION SEQUENCE - HANSON PLACE (WEST END)

- CONTRACTOR SHALL MOVE STORAGE MATERIALS FROM STAGING AREA #3 TO STAGING AREA #2.
- STAGING AREA #3 WILL BE USED FOR CONTRACTOR PROTECTION WHILE REMOVING AND INSTALLING THE CONCRETE CURB AND HALF OF THE SIDEWALK ALONG THE WEST END OF HANSON PLACE. STAGING AREA #2 SHALL BE USED FOR STORAGE OF CONTRACTOR MATERIALS.
- CONTRACTOR SHALL PLACE TEMPORARY PEDESTRIAN FENCING ON THE CONCRETE WALKWAY CLOSEST TO THE BUILDING TO ESTABLISH TEMPORARY PEDESTRIAN WALKWAY #3.
- ONCE THE CONCRETE CURB AND CONCRETE WALKWAY WORK IS COMPLETED CLOSEST TO THE WEST END OF HANSON PLACE, THE CONTRACTOR CAN USE STAGING AREA #3 AS A PEDESTRIAN WALKWAY AND COMPLETE THE CONCRETE WORK CLOSEST TO THE BUILDING.

CONSTRUCTION SEQUENCE - FORT GREENE PLACE

- CONTRACTOR SHALL MOVE STORAGE MATERIALS FROM STAGING AREA #2 TO STAGING AREA #3.
- STAGING AREA #2 IS TO BE REMOVED IN ITS ENTIRETY AND THE STREET RETURNED TO NORMAL USE. REPAIR DAMAGE CAUSED BY THE POSTS BEING SET IN THE ASPHALT (STREET).
- STAGING AREA #4 WILL BE USED FOR CONTRACTOR PROTECTION WHILE REMOVING AND INSTALLING THE CONCRETE CURB AND HALF OF THE SIDEWALK ALONG FORT GREENE PLACE. STAGING AREA #3 SHALL BE USED FOR STORAGE OF CONTRACTOR MATERIALS.
- CONTRACTOR SHALL PLACE TEMPORARY PEDESTRIAN FENCING ON THE CONCRETE WALKWAY CLOSEST TO THE BUILDING TO ESTABLISH TEMPORARY PEDESTRIAN WALKWAY #4.
- ONCE THE CONCRETE CURB AND CONCRETE WALKWAY WORK IS COMPLETED CLOSEST TO THE WEST END OF HANSON PLACE, THE CONTRACTOR CAN USE STAGING AREA #4 AS A PEDESTRIAN WALKWAY AND COMPLETE THE CONCRETE WORK CLOSEST TO THE BUILDING.

CONSTRUCTION SEQUENCE - FINAL

- ONCE ALL SIDEWALK WORK IS COMPLETED, CONTRACTOR TO REMOVE ALL REMAINING TEMPORARY FENCING USED TO DEFINE THE STAGING AREAS AND RETURN THE STREET TO NORMAL USE. REPAIR DAMAGE CAUSED BY THE POSTS BEING SET IN THE ASPHALT (STREET).

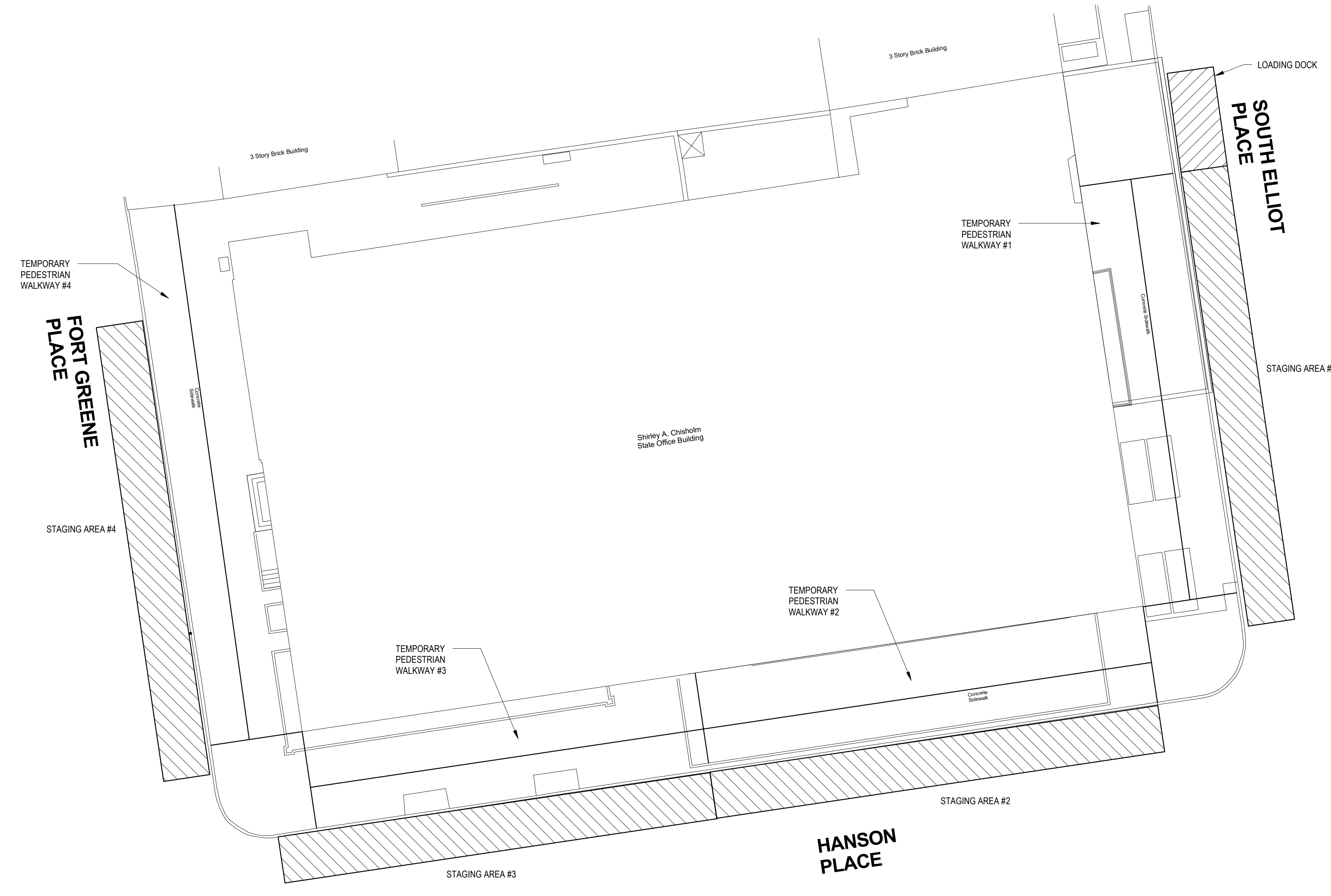

1 SITE STAGING PLAN
SCALE: N.T.S. PLAN NORTH

REVISED DRAWING 05/13/2025

EXISTING CONDITIONS LEGEND:

MONITORING WELL	MW
GAS VALVE	GV
WATER VALVE	WV
LIGHT POLE	LP
TRAFFIC SIGNAL POLE	TSP
FIRE HYDRANT	FH
TELEPHONE RISER	TR
CATCH BASIN	CB
STEEL GRATING	SG
BOLLARD	B
TRAFFIC SIGN	TS
FINISH FLOOR ELEVATION	FFE
POST INDICATOR VALVE	PIV
FENCE LINE	X
GROUND ELEVATION	515.00
GROUND CONTOUR	-515
PAVEMENT AREA	
CONCRETE AREA	
BUILDING AREA	

SITE REMOVALS LEGEND:

FULL DEPTH ASPHALT PAVEMENT	
CONCRETE	
STEEL FACED CONCRETE CURB	

KEY NOTES

- CURB INLET TO REMAIN.
- BRONZE HANDRAIL WITH BURIED CONTROLS TO REMAIN OPERATIONAL THROUGHOUT CONSTRUCTION.
- CON ED VAULTS, STREET BOXES, AND ANY OTHER TYPE OF GRATE OPENINGS TO BE COVERED WITH PLYWOOD ON BLOCKS ELEVATED 6" - 8" ABOVE GRATE TO ALLOW FOR AIR FLOW WHILE PREVENTING DEBRIS FROM FALLING THROUGH THE GRATE.
- NEW SIDEWALK CONCRETE, RAMP, AND CURBING TO REMAIN.
- NOT USED.
- EXISTING PLANTER TO REMAIN.
- CONCRETE SIDEWALK REMOVAL TO BE COORDINATED WITH STRUCTURAL FULL DEPTH SLAB REPLACEMENT AT AREAWAY.

FOR BIDDING PURPOSES, ASSUME EXISTING CONCRETE IS 4 INCHES THICK AND EXISTING SUBGRADE IS 12 INCHES THICK. THICKNESS TO BE VERIFIED IN THE FIELD.



1 REMOVALS PLAN
SCALE: 1" = 10'

REVISED DRAWING 05/13/2025

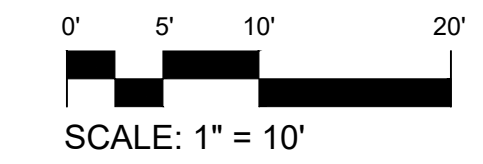

NEW YORK STATE OF OPPORTUNITY Office of General Services
DESIGN & CONSTRUCTION

CONSULTANT

DELTA
ENGINEERS, ARCHITECTS, & LAND SURVEYORS
CERTIFICATE OF AUTHORIZATION #: 019598

RYAN BIGGS CLARK DAVIS
ENGINEERING & SURVEYING
CERTIFICATE OF AUTHORIZATION #: 0018205

WARNING:
THE ALTERATION OF THIS MATERIAL IN ANY WAY, UNLESS DONE UNDER THE DIRECTION OF A COMPARABLE PROFESSIONAL, I.E. ARCHITECT FOR AN ARCHITECT, ENGINEER FOR AN ENGINEER OR LANDSCAPE ARCHITECT FOR A LANDSCAPE ARCHITECT, IS A VIOLATION OF THE NEW YORK STATE EDUCATION LAW AND/OR REGULATIONS AND IS A CLASS 'A' MISDEMEANOR.

STATE OF NEW YORK
FEDERICK C. ALLAN
080902
REGISTERED PROFESSIONAL ENGINEER
0225.05.13

CONTRACT: **CONSTRUCTION**

TITLE: **REPAIR BASEMENT CONCRETE & SIDEWALKS**

LOCATION: **SHIRLEY CHISHOLM SOB
55 HANSON PLACE
BROOKLYN, NY 11217**

CLIENT: **NEW YORK STATE OFFICE OF
GENERAL SERVICES**

MARK	DATE	DESCRIPTION
2	2025.05.13	ADDENDUM #3
1	2025.04.30	ADDENDUM #1
	2025.01.21	BID DOCUMENTS

PROJECT NUMBER: **47407-C**

DESIGNED BY: SAS

DRAWN BY: SAS

CHECKED BY: CJM

APPROVED BY: CJM

SHEET TITLE: **REMOVALS PLAN**

DRAWING NUMBER: **C-101**

Sheet 5 of 23

EXISTING CONDITIONS LEGEND:	
MONITORING WELL	MW
GAS VALVE	GV
WATER VALVE	WV
LIGHT POLE	LP
TRAFFIC SIGNAL POLE	TSP
FIRE HYDRANT	FH
TELEPHONE RISER	TR
CATCH BASIN	CB
STEEL GRATING	SG
BOLLARD	B
TRAFFIC SIGN	TS
FINISH FLOOR ELEVATION	FFE
POST INDICATOR VALVE	PIV
FENCE LINE	X

#	KEY NOTES
1	PROVIDE FULL DEPTH ASPHALT. SEE DETAIL 4/C-300.
2	PROVIDE CONCRETE SIDEWALK. SEE DETAIL 3/C-300.
3	PROVIDE STEEL FACED CONCRETE CURB (18" DEEP). SEE DETAIL 1/C-300.
4	PROVIDE RUBBERIZED ASPHALT SHEET MEMBRANE WATER PROOFING ON UNDERGROUND VAULTS. SEE DETAIL 6/C-300.
5	NUMBER NOT USED.
6	PROVIDE INLET PROTECTION. SEE DETAIL 6/C-301.
7	PROVIDE NEW SIGN POST. RE-USE EXISTING SIGN IF 2" MIN. EMBEDMENT IS NOT POSSIBLE DUE TO EXISTING CONDITIONS (IE UNDERGROUND VAULTS AND WALLS, ETC) EMBED TO EXTENT POSSIBLE. SEE DETAIL 5/C-300.
8	NUMBER NOT USED.
9	NUMBER NOT USED.
10	SEE DETAIL 7/C-300 FOR TYPICAL SECTION.
11	PROVIDE DROP CURB. SEE DETAIL 2/C-300.
12	PROVIDED WATERPROOFING ALONG BUILDING AND EXISTING SLAB. SEE DETAIL 8/C-301.
13	PROVIDE RUBBERIZED SHEET MEMBRANE FLASHING ALONG GRANITE CURB. SEE DETAIL 7/C-301.
14	NUMBER NOT USED.
15	CONCRETE SIDEWALK PLACEMENT TO BE COORDINATED WITH STRUCTURAL FULL DEPTH SLAB REPLACEMENT AT AREAWAY.
16	PROVIDE EXPANSION JOINT. SEE DETAIL 4/C-301.

SITE PLAN LEGEND:	
STANDARD DUTY ASPHALT PAVEMENT	[Pattern]
CONCRETE PAVEMENT	[Pattern]
INLET PROTECTION	[Pattern]
TOP OF CURB ELEVATION	TOC

GENERAL NOTES:

- 24 HOUR ACCESS TO DOORWAY AND LOADING DOCK REQUIRED. ADA ACCESS TO BE MAINTAINED AT ALL TIMES. CONTRACTOR TO COORDINATE WITH EIC AND OWNER ON ANY WORK THAT INTERRUPTS USE OF A DOORWAY OR LOADING DOCK.
- BICYCLE RACK MOVED DURING PREVIOUS PROJECT (#44798) TO BE RE-INSTALLED. LOCATION TO BE DETERMINED BY DIRECTOR'S REPRESENTATIVE.

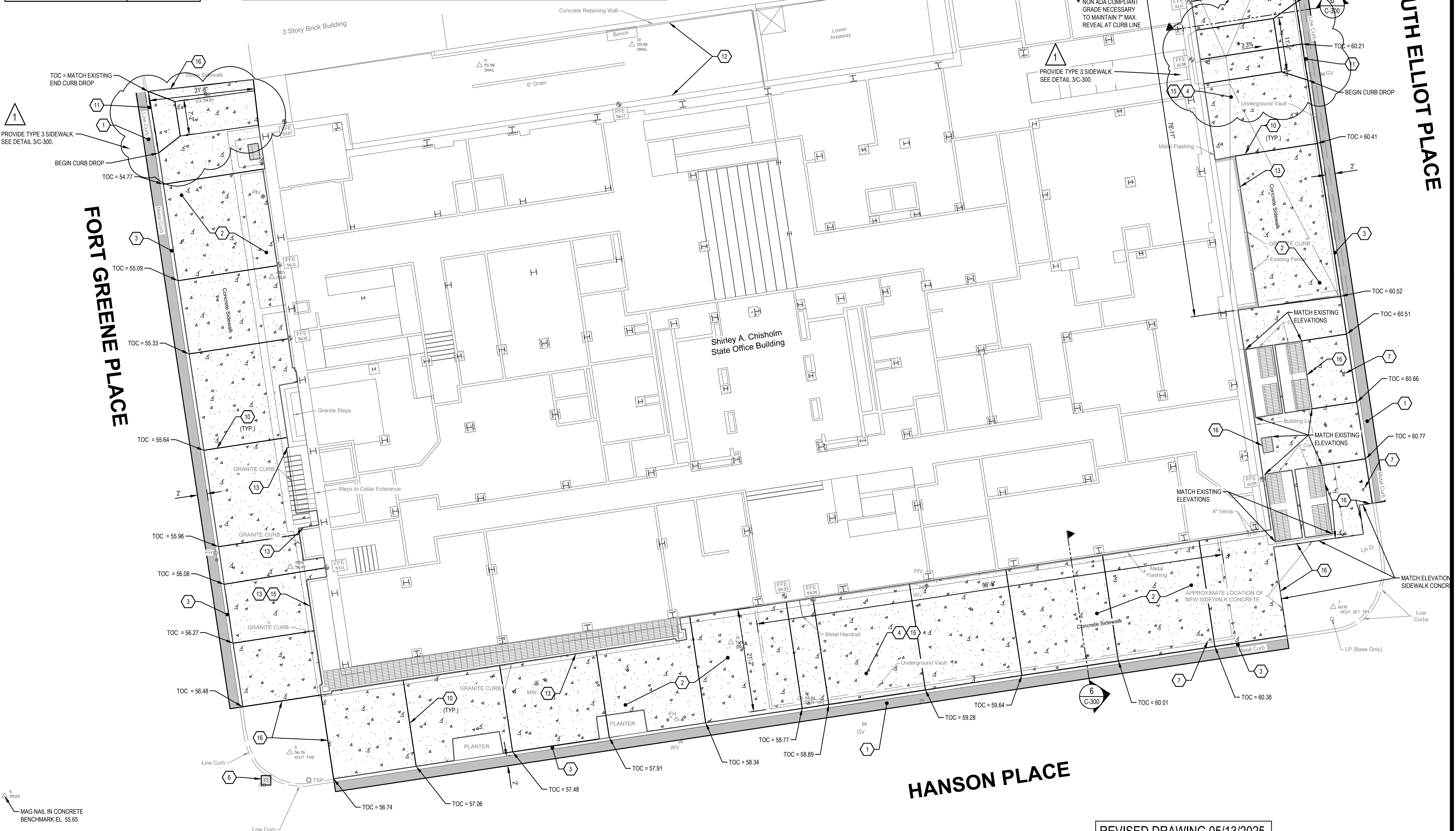

FORT GREENE PLACE

SOUTH ELLIOT PLACE

HANSON PLACE

1 SITE PLAN
C-200 SCALE: 1" = 10'

REVISED DRAWING 05/13/2025

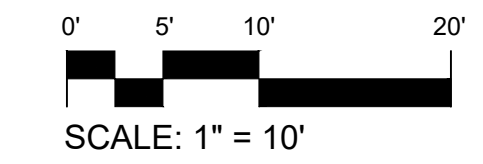

NEW YORK STATE OFFICE OF GENERAL SERVICES
Office of General Services
DESIGN & CONSTRUCTION

CONSULTANT
DELTA
ENGINEERS, ARCHITECTS, & LAND SURVEYORS
CERTIFICATE OF AUTHORIZATION # 019598

RYAN BIGGS CLARK DAVIS
ENGINEERING & SURVEYING
CERTIFICATE OF AUTHORIZATION # 0018205

WARNING:
THE ALTERATION OF THIS MATERIAL IN ANY WAY, UNLESS DONE UNDER THE DIRECTION OF A COMPARABLE PROFESSIONAL, I.E. ARCHITECT FOR AN ARCHITECT, ENGINEER FOR AN ENGINEER OR LANDSCAPE ARCHITECT FOR A LANDSCAPE ARCHITECT, IS A VIOLATION OF THE NEW YORK STATE EDUCATION LAW AND/OR REGULATIONS AND IS A CLASS 'A' MISDEMEANOR.

Professional Engineer Seal for Frederick C. Allard, No. 088902, State of New York, expires 05.13.2025.

CONTRACT:	CONSTRUCTION
TITLE:	REPAIR BASEMENT CONCRETE & SIDEWALKS
LOCATION:	SHIRLEY CHISHOLM SOB 55 HANSON PLACE BROOKLYN, NY 11217
CLIENT:	NEW YORK STATE OFFICE OF GENERAL SERVICES

MARK	DATE	DESCRIPTION
1	2025.05.13	ADDENDUM #3
	2025.01.21	BID DOCUMENTS
		DESCRIPTION
PROJECT NUMBER:	47407-C	
DESIGNED BY:	SAS	
DRAWN BY:	SAS	
CHECKED:	CJM	
APPROVED:	CJM	
SHEET TITLE:	SITE PLAN	
DRAWING NUMBER:	C-200	

Sheet 6 of 23

